

Vyhrievacie obruče sú vyrobené z nerezú alebo mosadze s mikanitovou alebo keramickou vnútornou izoláciou. Keramické obruče sú charakteristické vynikajúcimi izolačnými vlastnosťami a dlhodobou prevádzkou.

Charakteristika

- dizajn s mikanitovou alebo keramickou izoláciou
- plášť s dodatočnou adiabatickou charakteristikou
- hermeticky utesnený koniec
- možnosť použitia vnútorného termočlánku

Špecifikácia

- plášť: uhlíková oceľ, mosadz, Cr-Ni oceľ
- napájanie: 220V až 3x400V
- vnútorný priemer: 18 až 1000 mm
- spôsob ukončenia: kábel, blok, skrutka



Parameters	In micanite insulation	In ceramic insulation
Heater diameter	ø25+1000 [mm]	ø50+1500 [mm]
Width	25+1000 [mm]	40+1000 [mm]
Thickness	3,5+4 [mm]	12+32 [mm]
Supply voltage	220V, 230V, 380V, 3x380V, 400V, 3x400V, or other	
Surface loading	4,5W/cm ²	7W/cm ²
Maximum temperature	450°C	550°C
Allowable temperature	500°C during fine heat transfer	600°C during fine heat transfer
Enclosure	steel Cr-Ni (AISI 321), brass	steel Cr-Ni (AISI 321)
Additional options	- an adiabatic sheath holding heat radiation outside (of 25%) - possibility for applying thermocouple J, K, T - hermetic termination * Type and way of power supply connections acc. to the figures or requirements	- an adiabatic sheath holding heat radiation outside (of 25%) - possibility for applying thermocouple J, K, T * Type and way of power supply connections acc. to the figures or requirements

Type A

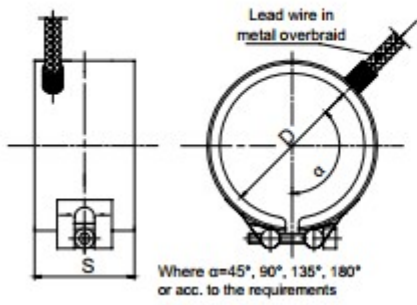

Type B

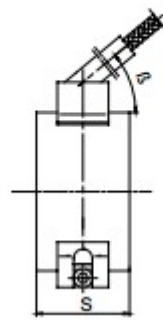

Type C

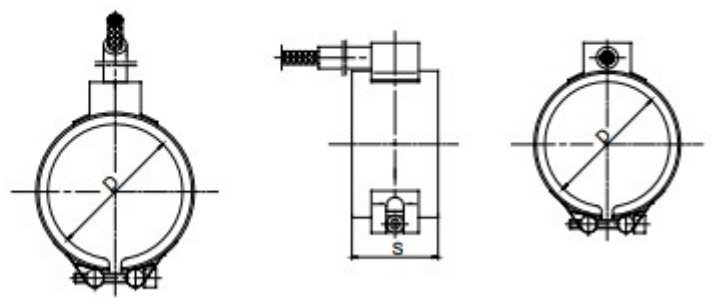

Type D

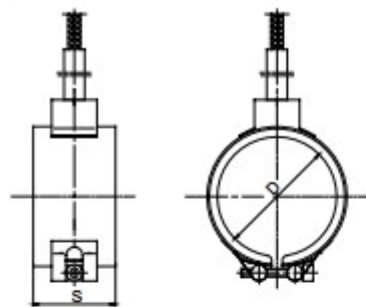

Type E

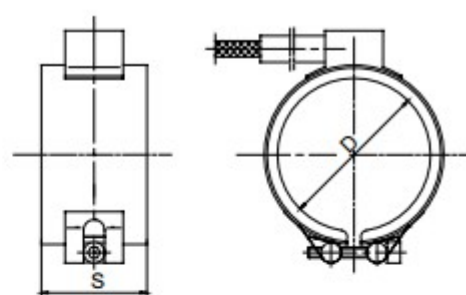

Type F

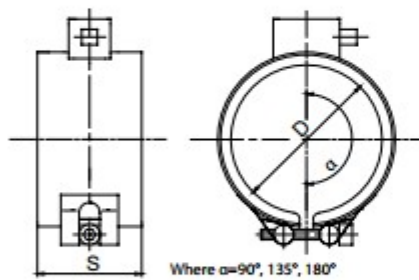

Type G

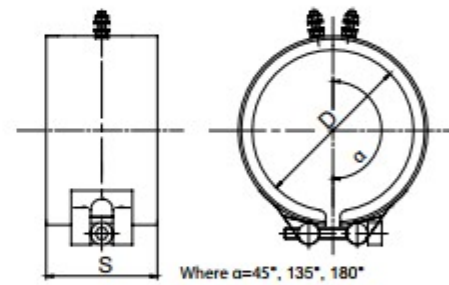

Type H

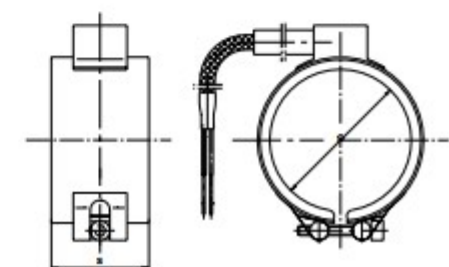
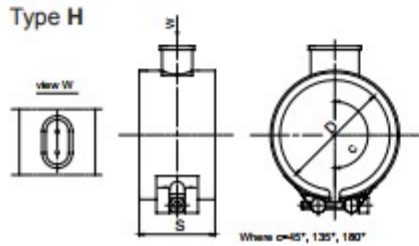

Product code

		Type	
1	<input type="text"/>	GM	micanite
		GC	ceramics
2	<input type="text"/>	Diameter [mm]	
			parameters acc. to requirements
3	<input type="text"/>	Width [mm]	
			parameters acc. to requirements
4	<input type="text"/>	Power [W]	
			parameters acc. to requirements
5	<input type="text"/>	Voltage [V]	
			parameters acc. to requirements
		Transmission type	
		A	directly form the heater in overbraid
		B	axial (angle 3+70°)
		C	axial flat
		D	radial
		E	tangent flat
		F	with block
6	<input type="text"/>	G	screw: M5
		H	plug
		Additional options	
		O	without
7	<input type="text"/>	OS	adiabatic sheath
		Ws	insulated lead wire, up to 400°C with steel overbraid
8	<input type="text"/>	Lead wire length [m]	
			parameters acc. to requirements

1 2 3 4 5 6 7 8
 - - - - - - -

Ordering example: **GC-50x80-500W/230V-E-Ws-0,5m**